

PARET-ONE®

CE MARKED PRODUCT

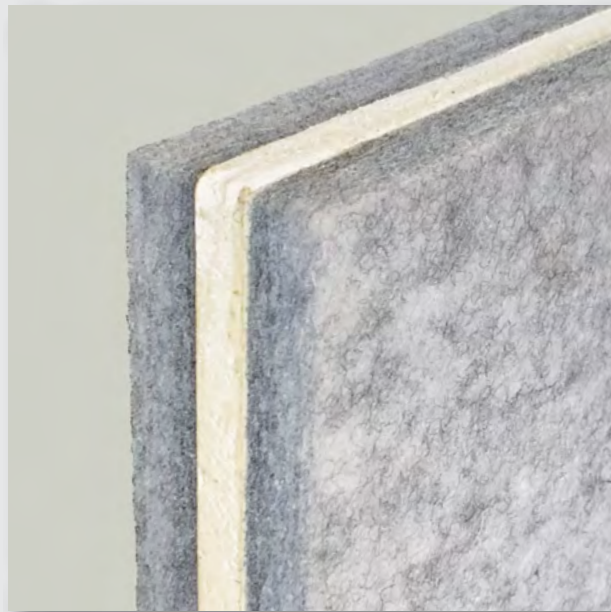

WIDTH 1200 mm

LENGTH 2000, 3000 mm



THICKNESS 52 mm

WEIGHT 16 Kg/m²

THERMAL CONDUCTIVITY Polyester fiber $\lambda = 0,035$ W/mK
Plasterboard $\lambda = 0,21$ W/mK

REACTION TO FIRE Polyester fiber B-s2, d0
Plasterboard A2-s1, d0

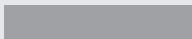
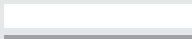
COMPOSITION Try-layer product composed by:

-  **A** Polyester fiber 20 mm
-  **B** Plasterboard 12,5 mm
-  **C** Polyester fiber 20 mm

PARET - ONE® IS THE TRIPLE LAYER PRODUCT FOR INSULATION OF VERTICAL WALLS BETWEEN HOUSING UNITS

MATERIAL

Paret-One® is a three-layer product achieved by combining a plasterboard panel decoupled from a double layer of variable density polyester fiber with excellent thermal and acoustic insulation characteristics.

FIELDS OF APPLICATION

It is widely used in partitions, where a high level of soundproofing together with good thermal insulation characteristics is required. The high level of soundproofing characteristics of the product make it the best choice for divisor walls between housing units.

INSTALLATION

Paret-One® boards have to be installed with the utmost care, paying attention to the continuity of the panel. Paret-One® is installed by bonding to the existing walling, fastened using FORTEGEM dB+ cement mortar. Once the installation has been completed it is possible to proceed with building a second perforated brick cladding wall.

APPLICATIONS

SOUND INSULATION



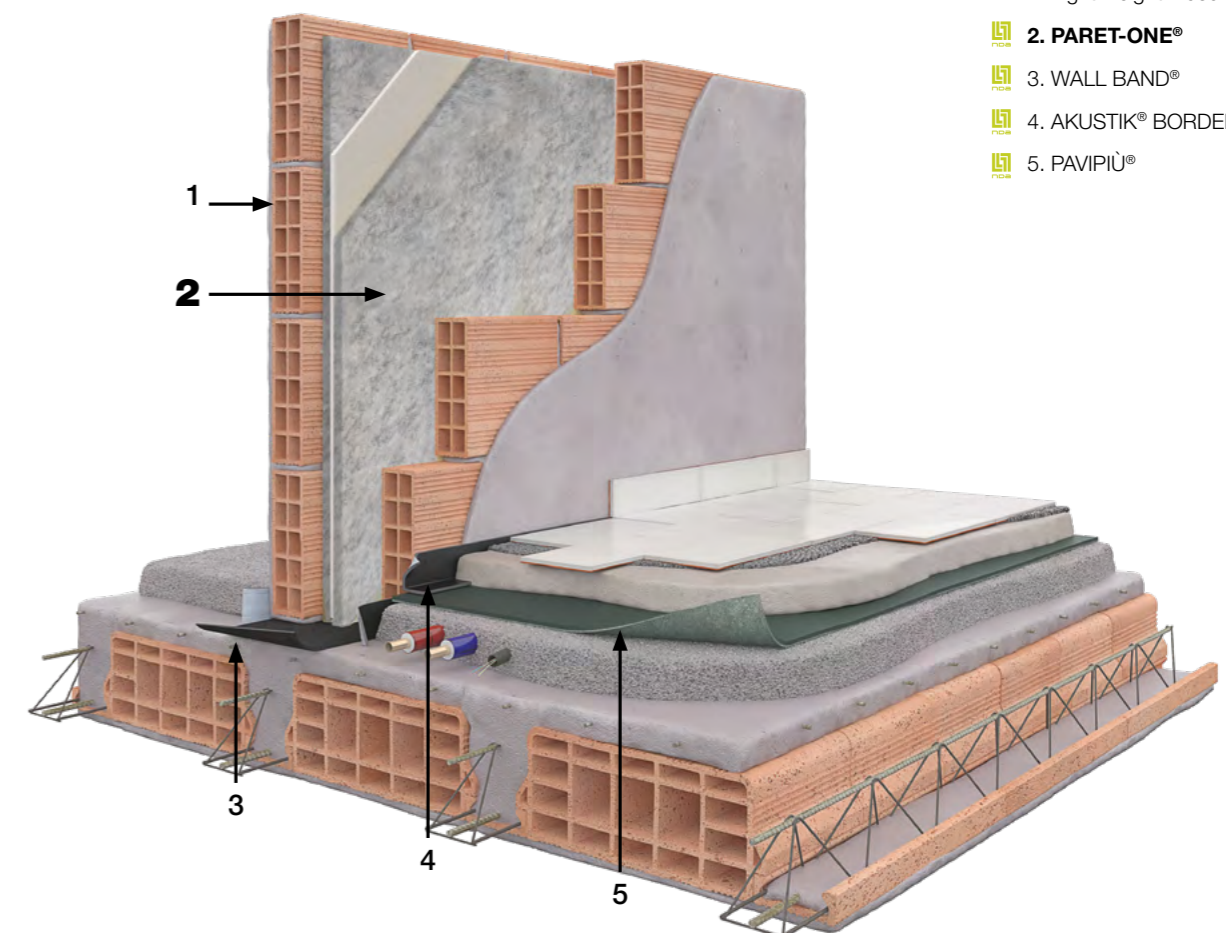

ACOUSTIC INSULATION OF VERTICAL PARTITIONS IN TRADITIONAL BUILDINGS WITH HIGH PERFORMANCE PRODUCTS

R'_w = 60 dB

value on on-site test



LEGEND

1. Light weight masonry
-  2. PARET-ONE®
-  3. WALL BAND®
-  4. AKUSTIK® BORDER
-  5. PAVIPIÙ®